

Guide to Using the ImageCast Ballot Marking Device (BMD)

With the ImageCast BMD, any voter can mark and cast a paper ballot privately and independently. These instructions will improve your accessible voting experience with the ImageCast BMD.

NOTE: If this is your first time using the BMD, your voting session may take longer than you expect it to. Please be prepared and make arrangements to spend up to an hour at the poll site.

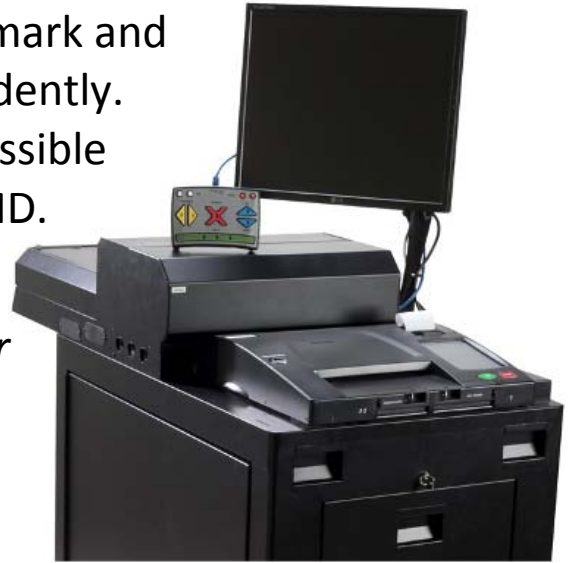

You can use one of three assistive devices to navigate the ballot:



ATI (Audio Tactile Interface)

The ATI is a Braille-enhanced handheld controller. The ATI is the quickest and easiest device for voters who are able to push buttons firmly.



Paddle Buttons

Paddles are ideal for voters who may have difficulty pushing buttons on the ATI. Voters control all ballot navigation and selections with a press on the L (left) or R (right) paddle when prompted by the audio track.



Sip-N-Puff (Gooseneck or Headset)

The Sip-N-Puff is a good option for voters who do not have use of their hands or feet. Voters control all ballot navigation and selections with a “Sip” or a “Puff” when prompted by the audio track.

Audio Ballot Options



The BMD can play an audio track of all the ballot content along with navigational instructions specific to the assistive device you choose.

You can disable the audio track to make voting faster, but this is not recommended for voters who are not familiar with the accessible device or voters with reduced vision.

Ballot Display Options

With all assistive devices, you also have the option of navigating with the screen on or off. If you can read the ballot but need it zoomed in, it is recommended that you keep the display on as well as the audio track. This will give you the benefit of using both sight



and hearing as you navigate the ballot. During the instructions, you will be able to change the zoom and contrast of the ballot display.

Starting an Accessible Voting Session:

- Request to use the BMD with the ATI (or another device).
- Let the poll worker know if you want the display to be on.
- If you are using the ATI, it may be helpful to familiarize yourself with the buttons before the voting session begins. Instructions and tips for using the ATI are included within this guide.
- If you are using headphones, be sure to put them on before the voting session begins.

You may notice pauses in the audio track. Please be patient as it guides you through the ballot.

Marking and Casting Your Ballot:

The ImageCast BMD provides you with step-by-step instructions on how to use the device before and during your voting session.

This is a picture of the ATI (Audio Tactile Interface):

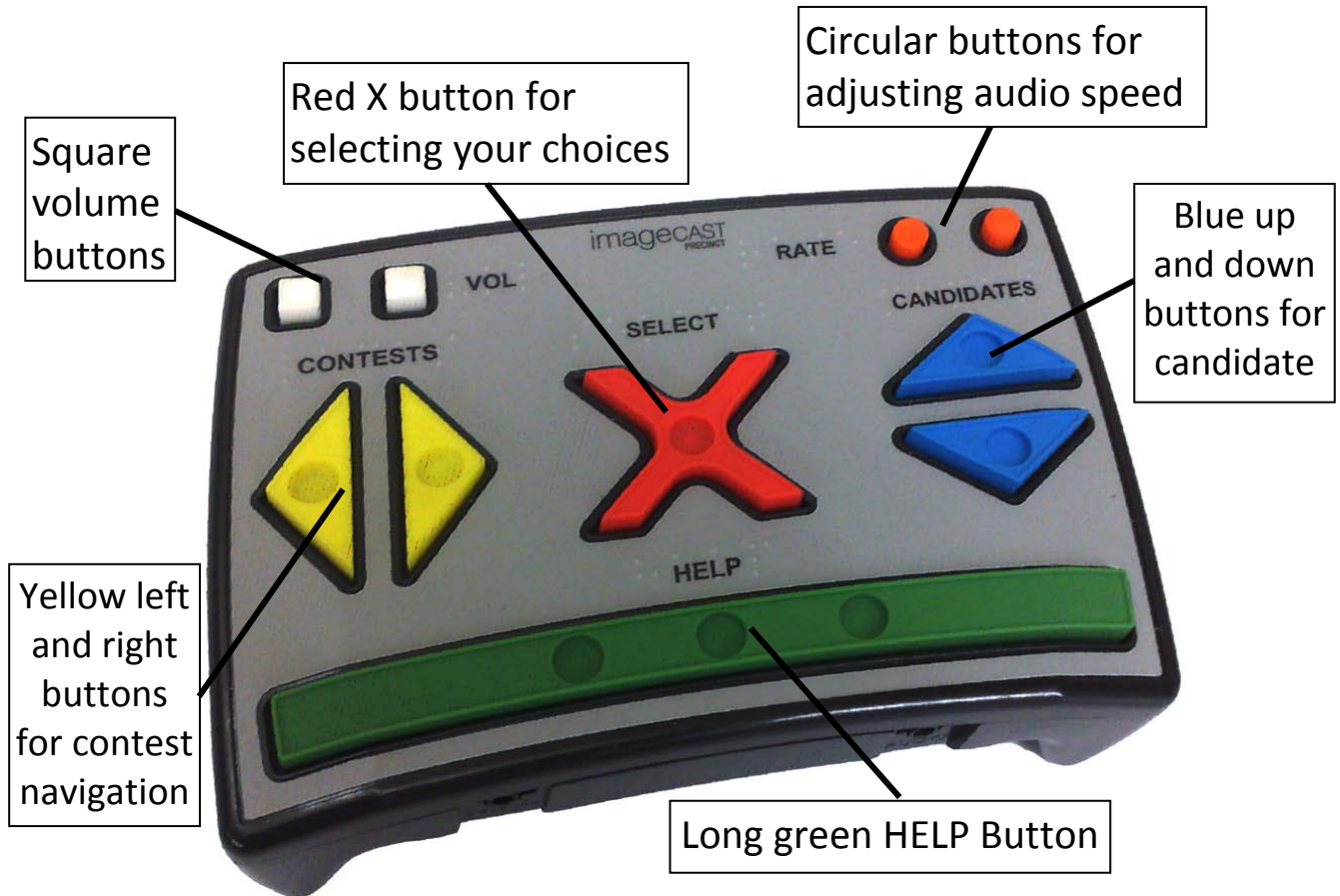

Navigational buttons on the ATI have a circular hole in the center of the button. When pushing a button, please press the center of it firmly for one second.

It may take a moment for the machine to respond. Please be patient and avoid pounding the buttons.

If your selection does not register or if you do not push any buttons, the previous instruction will repeat again after 20 seconds.

ATI Buttons Descriptions

- The blue up and down arrows on the right side of the ATI are used for moving through the list of choices within a contest. **You need to push these buttons every time you want to go to the next candidate.**
- To select a candidate, press the red X button in the center of the ATI. An audio prompt tells you when your vote is registered. Pressing the red X button again will deselect the candidate.
- The yellow arrows that point right and left are for moving between contests. When you reach the end of the first ballot page, pressing this 'next contest' right arrow button will bring you to the propositions on the next page (if there are any).
- If you need assistance or would like to pause the voting session, please press the green help button at the bottom of the ATI.

Completing your Voting Session

At the end of the ballot, you have the option to review your ballot selections and make any desired changes or to skip the review and proceed to printing out your marked paper ballot.

You will then have the choice of inserting the ballot into the tabulator yourself or asking the poll worker, who will use a privacy sleeve, to insert it into the tabulator for you. After the ballot is successfully cast, the tabulator will deposit it into the ballot box.

